

Max. arbejdsdruk / Max. working pressure: 25 / 16 bar
 Max arbejdsstemperatur / Max working temperature: 195 °C

Pladeantal / No. of plates	n
Dimension L (mm)	10 + 2,7 x n
Tomvægt / Empty weight (kg)	40 + 1,5 x n
Areal / Area (m ²)	0,29 x n

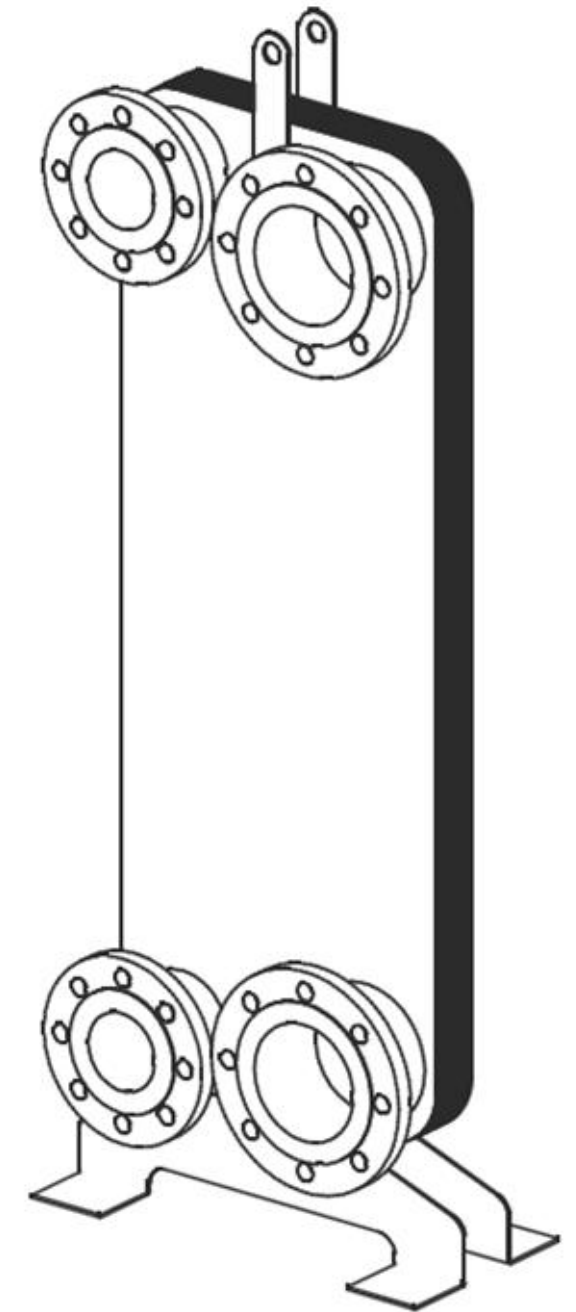
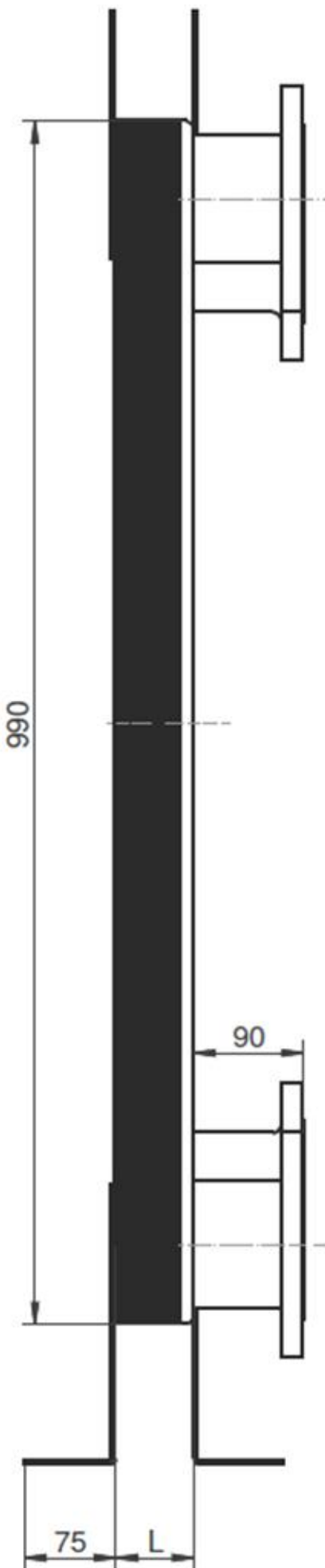
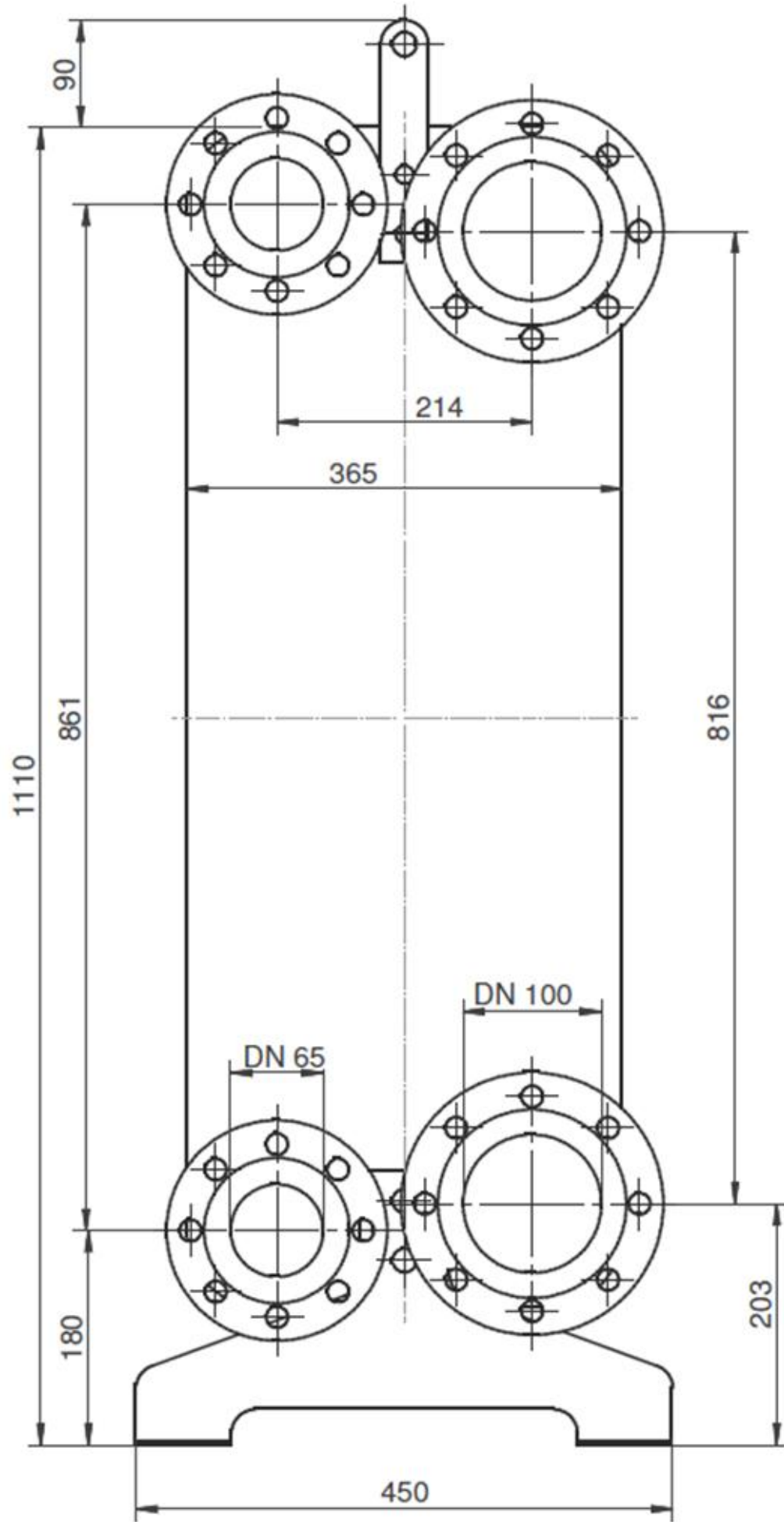

SPX Flow Technology Danmark A/S

Platinvej 8, 6000 Kolding, Denmark
 Tel.: +45 70 278 444
 Fax: +45 70 278 445
 www.SPXFT.com

Weight kg:

Drawn:
 07-01-2013 HeM

Approved:
 07-01-2013 cmc

Sheet no:
 1

PARABRAZED TT97

Archive:

Material:

APV®

Basis no.:

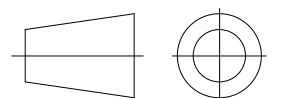

Drawing no.:
 TT97

Rev.
 0